

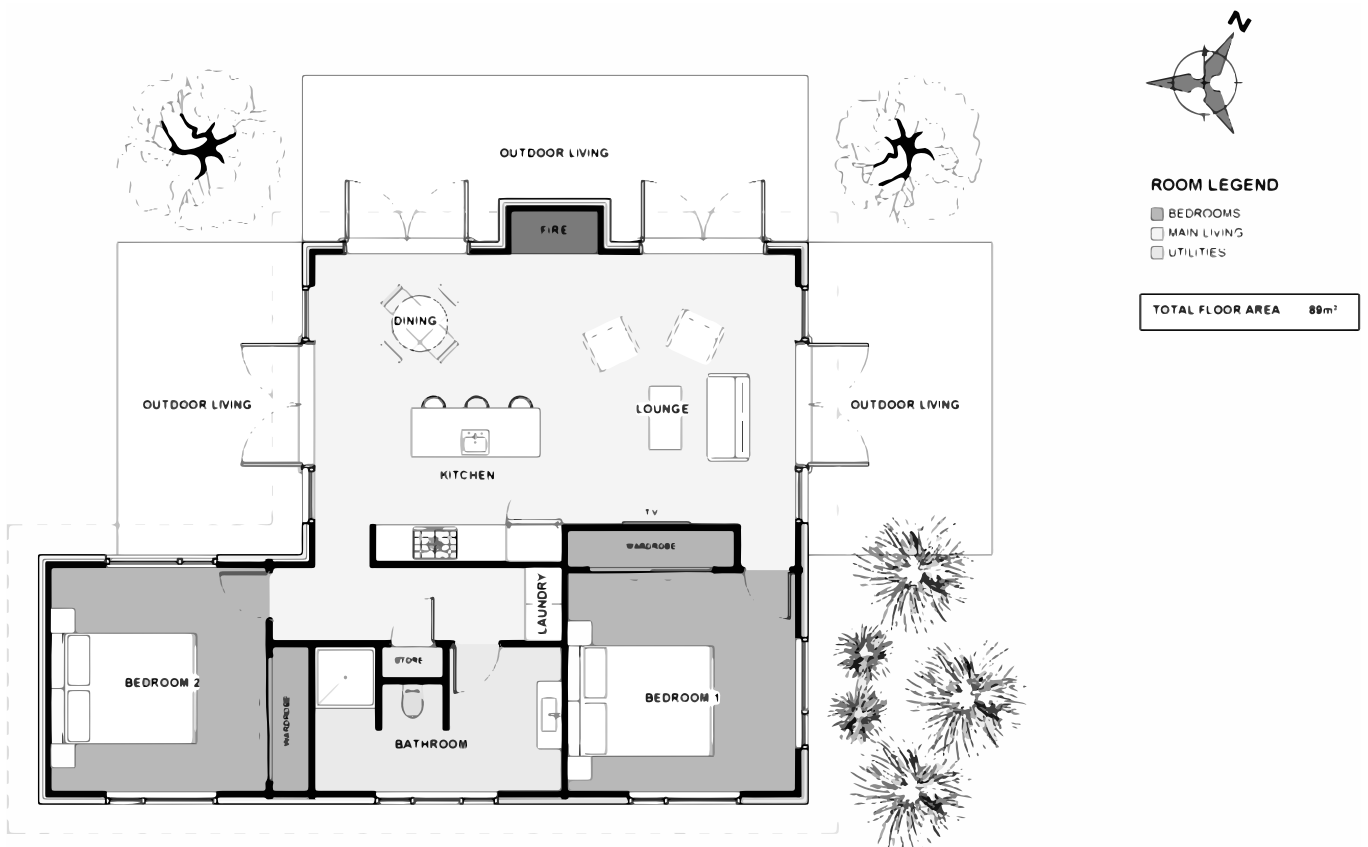

Need an affordable comfortable home? The 'Tawa' is perfect. 2 bedrooms with good sized wardrobes, open plan living easily heated with the centralised fireplace & great 180° views & courtyard surround. This home can be finished in any cladding/ colour and even have its roof changed to a mono pitch! It's up to you.



Floor Area: 89m<sup>2</sup>

0 cars, 2 bedrooms, 1 bathroom, 12.3m wide, 9.6m deep

**Contact**

Telephone: (03) 789 8560

Mobile: 027 632 3808

Email: natcon@xtra.co.nz

Visit us: www.naturalconstruction.co.nz

