

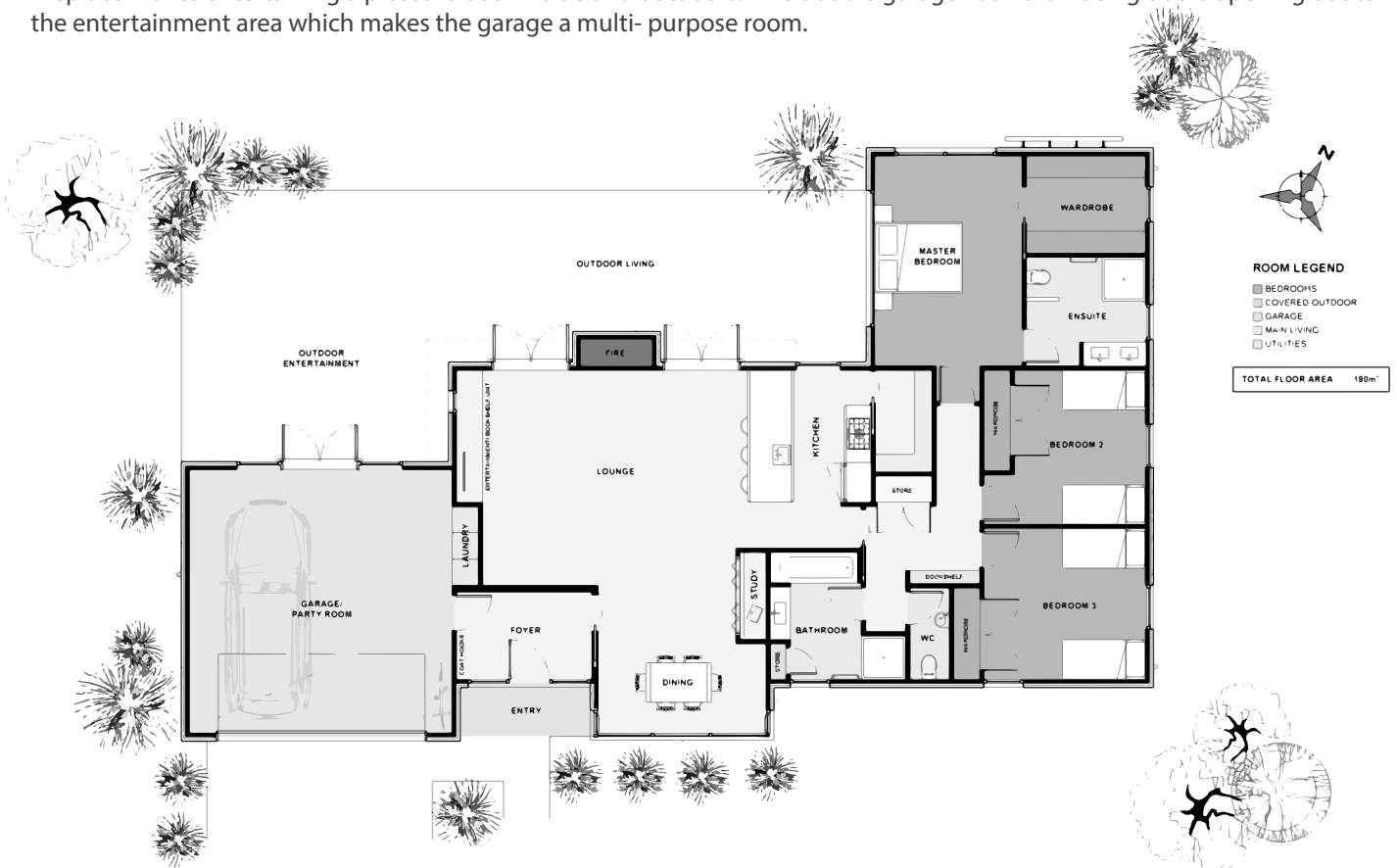

The 'Koromiko' just works and looks great while doing it. 3 Bedrooms are neatly arranged down the North/ Eastern side allowing all rooms to receive the lovely morning sun. The main living area has an extra high ceiling due to the elevated roof with glazing allowing light to beam from above giving the room an amazing feel with this natural light source. A back to back fireplace makes entertaining a pleasure both inside and outdoors. The double garage has north facing doors opening out to the entertainment area which makes the garage a multi- purpose room.



Floor Area: 190m²

2
 3
 2
 22.0m
 13.3m

Contact

Telephone: (03) 789 8560

Mobile: 027 632 3808

Email: natcon@xtra.co.nz

Visit us: www.naturalconstruction.co.nz

